

DOUBLE PIN

TYPICAL LAYOUT

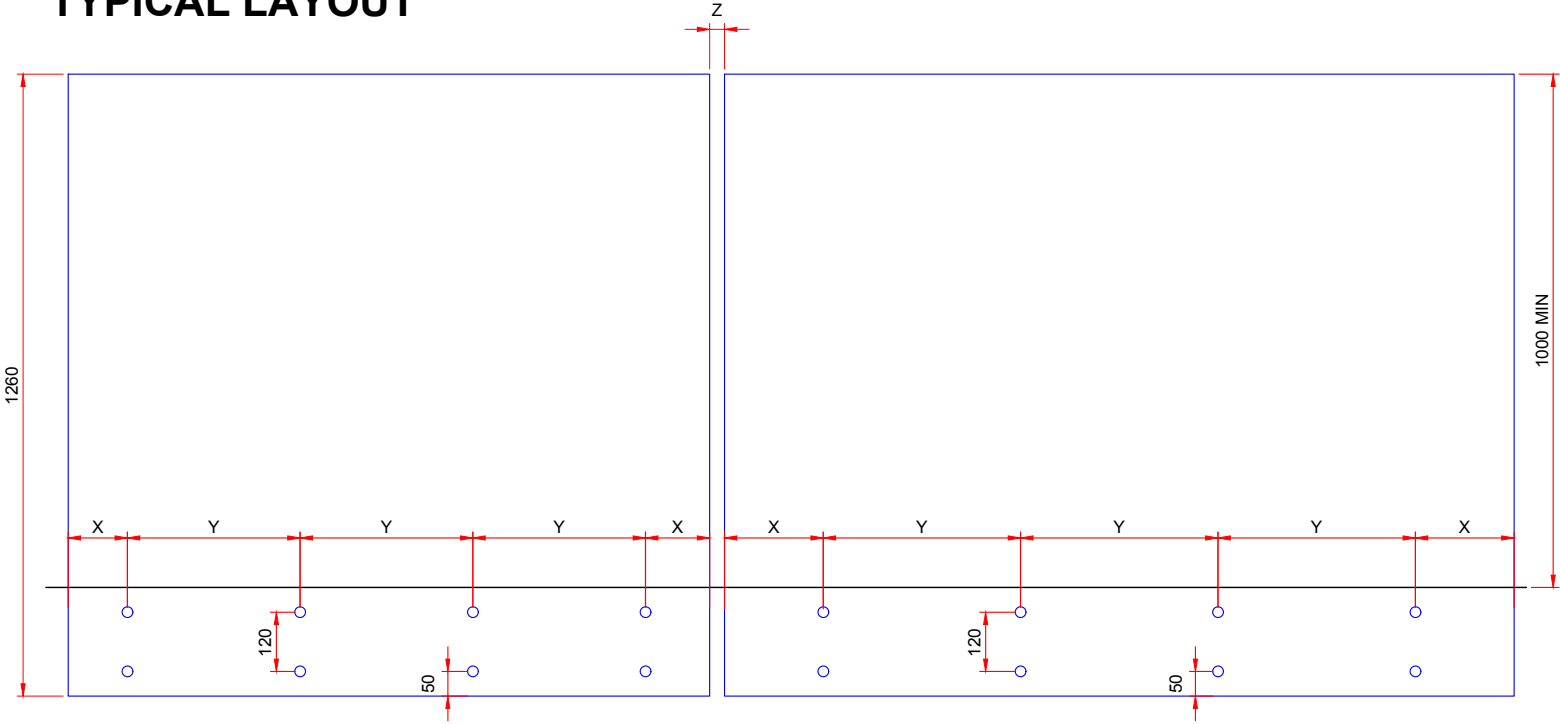

CORNER CONFIG.

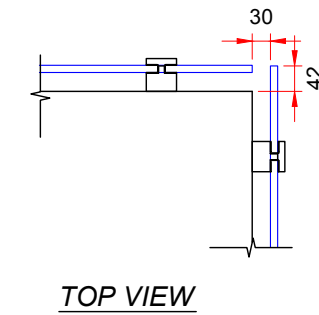

Important:

Before you install your project, please read this installation guide carefully, consider the gap between each part, calculate the exact hole position before drilling.

The corners and edges of toughened glass are its weakest points, so ensure they are well-protected during installation.

Always use rubber spacers to separate stainless steel hardware from the glass to avoid damage.

After completing the installation, it is essential to clean both the glass and the hardware. Proper cleaning of the glass helps maintain its protective coating, and cleaning the hardware removes any metal debris from the installation process, preventing potential rust.

Additionally, regular cleaning afterward is recommended to ensure long-term durability and maintain optimal performance.

FIXING DETAIL

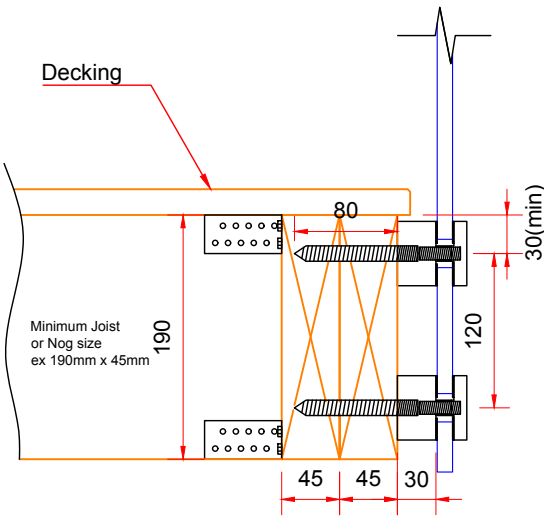

CONNECTION TO TIMBER

FOR TIMBER AND COACH SCREW
DOUBLE JOISTS REQUIRED
STANDARD PINS:
USE M8 DRILL BIT PRE DRILL ALL HOLES,
THEN M10 COACH SCREWS
ADJUSTABLE PINS:
USE M10 DRILL BIT PRE DRILL ALL HOLES,
THEN M12 COACH SCREWS

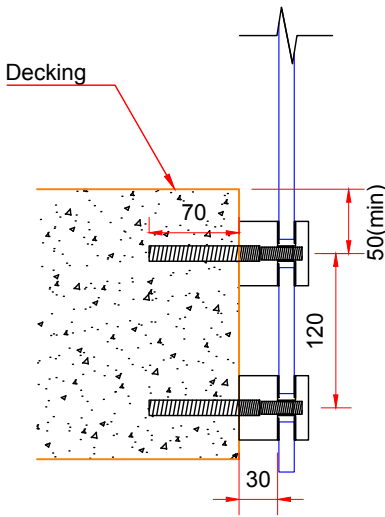

CONNECTION TO CONCRETE

FOR CHEMSET:
25 MPa MIN, CONCRETE STRENGTH
STANDARD PINS:
USE M12 DRILL BIT PRE DRILL ALL HOLES,
THEN M10 PIN RODS
ADJUSTABLE PINS:
USE M14 DRILL BIT PRE DRILL ALL HOLES,
THEN M12 PIN RODS

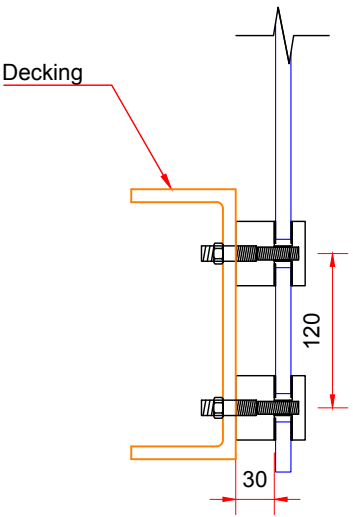

CONNECTION TO STEEL BEAM

FOR STEEL BEAM:
STANDARD PINS:
USE M12 DRILL BIT PRE DRILL ALL HOLES,
THEN M10 PIN RODS
ADJUSTABLE PINS:
USE M14 DRILL BIT PRE DRILL ALL HOLES,
THEN M12 PIN RODS

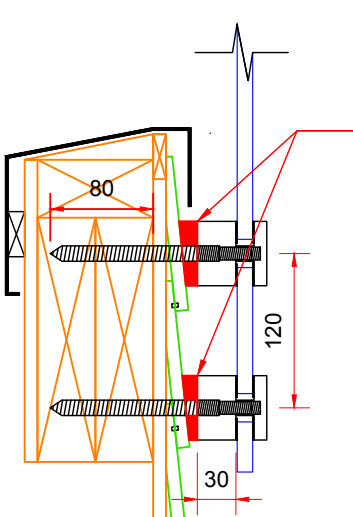

CONNECTION TO WEATHER BOARD

FOR WEATHER BOARD AND WEATHER BOARD,
DOUBLE JOISTS REQUIRED
STANDARD PINS:
USE M8 DRILL BIT PRE DRILL ALL HOLES,
THEN M10 COACH SCREWS
ADJUSTABLE PINS:
USE M10 DRILL BIT PRE DRILL ALL HOLES,
THEN M12 COACH SCREWS

Solid Packer(Treated)
as per Grand Glass Ltd
- ensure solid bearing
- no gap in between

ADJUSTABLE FUNCTION

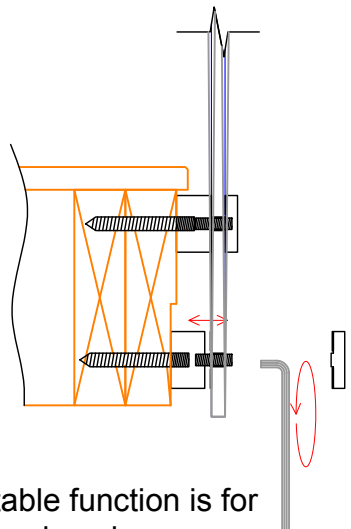

* This adjustable function is for
adjustable pin only.

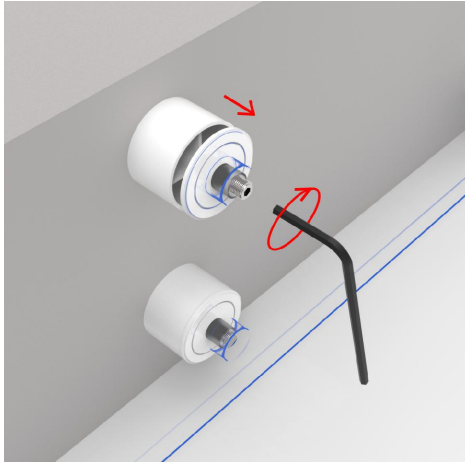

For more detailed information, please contact the team: email sales@grandglass.co.nz ph 09 478 9778 or 027 755 7705 www.grandglass.co.nz



ADD: 18a Parkway Drive, Rosedale. PH: 09 478 9778 , 027 755 7705

Grand Glass Double Pin System Installation Guide

Complies with NZS3604:2011

Drawn By : SW	Date : 1/29/2025	Paper Size : A3
Checked By : JQ		Scale : NTS
Drawing No. : GGH-DP01		Rev. No. : 0
		Sht. No. : 1